



Turn the LED display on - Press Left key for 3 seconds.

**Pressure/Temperature Unit setting (default setting is Bar/°C):** Long press "M" menu key for 3 seconds until "U/S" (Units setup) is displayed, short press "left/right select key" to change pressure unit to Bar or PSI, confirm by short press of "M" menu key. Then set temperature unit setting, short press left/right select key °C or °F, confirm by short press of "M" menu key.



For threshold setting (defaults are low pressure 1.8 Bar & high pressure 3.2 Bar, high temperature is 70°C. Long press "M" menu key for 3 seconds until "U/S" (Units Setup) is displayed then short press "M" menu key twice to enter "P/T" (Pressure threshold) interface. First value is "low pressure of front tires". To select pressure short press "left/right keys until desired pressure setting is displayed. Short press "M" menu key to save and go to next setting. Repeat this process for "high pressure of front tires" - "low pressure of rear tires" & "high pressure of rear tires" - For Tyre Temperature threshold, Long press "M" menu key for 3 seconds until "U/S" (Units setup) is displayed then short press "M" menu key 3 times to enter "T/T" (Temperature Threshold) interface. Repeat the above process to set "high temperature of tires".



**Default setting:** Long press "M" menu key for 3 seconds until "U/S" (Unit setup) is displayed then short press "M" menu key several times to enter DE (Default setup) interface. Long press left/right keys for 2 seconds to restore default. Default reset is confirmed when "DF" appears on display.

**FOR USE ON SINGLE AXLE CARAVANS SIMPLY CONNECT THE "FL & FR" SENSORS. DISPLAY WILL READ ZERO FOR REAR LEFT & RIGHT TYRES. FOR TWIN AXLE CARAVANS THE SENSORS WILL WORK AS PER VEHICLE TYRE SETTINGS.**

**WARRANTY:** The 12 month warranty on this product will need to be activated within 30 days of purchase, please go to our web site and click on the "Warranty" link and enter your details on the warranty screen. [www.streetwizeaccessories.com](http://www.streetwizeaccessories.com).

See [Streetwize website](http://Streetwize website) for up-to-date manual, search for "TPMS1" or LW612

**Streetwize Accessories:** Trafford Park, M17 1RY  
**Technical enquiries:** [support@streetwizeaccessories.com](mailto:support@streetwizeaccessories.com)  
**Telephone:** 0161 447 8597  
[www.streetwizeaccessories.com](http://www.streetwizeaccessories.com)



# Solar/USB Power Tyre Pressure Monitoring System

**Suitable for  
 CARS, VANS, SUV's & 4X4's,  
 CARAVANS, MOTORHOMES  
 & TRAILERS.**



**BAR/PSI OR °C/°F  
 UNIT DISPLAY**

Tyre Pressure Monitoring System (TPMS1/LW612). This system is designed to make driving safer for cars, vans, SUV's, 4x4's, motorhomes & towing caravans & trailers, providing real-time monitoring of tyre pressures and temperature. If any abnormal pressures or temperatures are detected an audio warning will sound along with a visual warning on the TPMS1 display. The system is designed to improve vehicle ride and driving safety, whilst reducing vehicle & tyre wear, offering greater fuel efficiency. Please read and understand these instruction carefully before any use of the product and retain for future reference.

Specifications			
Operating Voltage:	3.7 - 5V	Display:	LCD Mono Screen
Operating Temperature:	-20°C - 75°C	Operating Temperature:	-30°C - 80°C
Operating Current:	<10mA	Standby Current:	<3mA
RF Transmission Frequency:	433.92MHz ± 50KHz	RF Signal Reception Sensitivity:	90dbm

**PLEASE NOTE:** Upon initial correct installation of sensors, connection of pressure and temperature data to the display unit should be automatic. However, this may take a few minutes and can be assisted by driving the vehicle a short distance. If you wish to change the pressure or temperature units or to change the low or high pressure/temperature defaults, see descriptions enclosed in this manual.





## Description

- Power Port: Connect power cable when charging
- Right Key: Select key of menu
- Menu Key: Long press into menu setting
- Left Key: LEFT Select Key & **ON/OFF (hold for 3 seconds)**

**Max. operating distance**  
**Up to 30 metres**

## Display interface

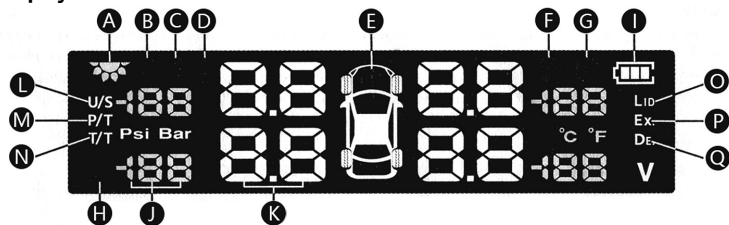

- |  |  |
|--|--|
| <b>A</b> Solar Power icon              | <b>J</b> Current tire temperature values |
| <b>B</b> Low power of sensor icon      | <b>K</b> Current tire pressure values    |
| <b>C</b> Leakage warning icon          | <b>L</b> U/S: Units setup                |
| <b>D</b> High temperature warning icon | <b>M</b> P/T: Pressure threshold         |
| <b>E</b> TPMS alarm icon               | <b>N</b> T/T: Temperature threshold      |
| <b>F</b> High pressure warning icon    | <b>O</b> LID: Learn ID                   |
| <b>G</b> Low pressure warning icon     | <b>P</b> EX: Exchange                    |
| <b>H</b> No signal warning icon        | <b>Q</b> DE: Default setup               |
| <b>I</b> Battery status of receiver    |  |

**Leakage Warning:** When any of the tyre pressures decrease to 0.3 bar an audio warning will sound and the pressure & temperature display for the tyre concerned will flash.

**Low pressure warning:** When pressure of any tyre is lower than the low pressure alarm threshold, an audio warning will sound and the pressure & temperature display for the tyre concerned will flash. Default low pressure alarm threshold is set at 1.8 bar, please consult vehicle manual for correct tyre pressure.

**High pressure warning:** When pressure of any tyre is Higher than the pressure alarm threshold an audio warning will sound and the pressure & temperature display for the tyre concerned will flash. Default high pressure alarm threshold is set at 3.2 bar, please consult vehicle manual for correct tyre pressures.

**High temperature warning:** When temperature of any tyre is Higher than the threshold an audio warning will sound and the pressure & temperature display for the tyre concerned will flash. Default high temperature alarm threshold is set at 70°C.

**Low power warning:** When the voltage of the internal battery is lower the 2.4V an audio warning will sound and the pressure & temperature display and low power icon will flash.

**Low power warning (cont):** When voltage of display's battery (lithium battery 800mAh) is lower than 5% an audio warning will sound. Battery icon on display will flash at the same time. The display will automatically turn off after 5 minutes. Although "solar cell" will keep the battery topped up you can recharge battery using (5V 1.5A) USB cable (NOT SUPPLIED).

**No signal warning:** When the display stops receiving data from the sensors an audio warning will sound and the pressure & temperature display and no signal icon will flash. The signal can be interrupted for several reasons including, too close to interference, sensor loss, sensor damage, low power, no pressure of tyre.

**Sensor installation:** Tyre Pressure Monitoring System includes

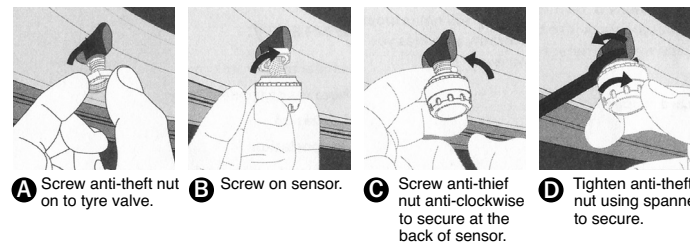
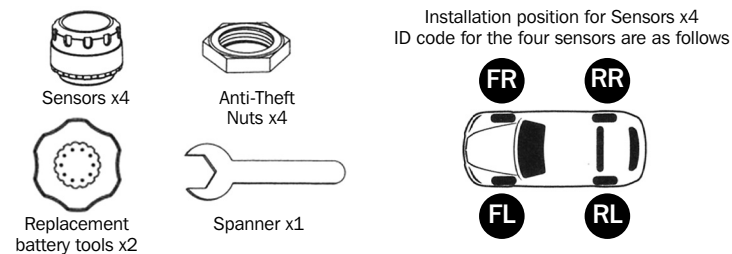

**Please Note:** It is advisable to always add some grease to the tyre valve before applying the sensor.

**Battery Replacement:** If the pressure readings stop working, in the first instance replace the battery, type CR1632 - To remove the sensors reverse the process above.

